

THE CITY OF NAPOLEON

BUILDING & ZONING DEPARTMENT

255 W. RIVERVIEW

(419) 592-4010

Building Permit

Permit Number: BP2009-105

Page 1 of 1

Printed: 9/22/2009

ADDRESS:

825 Clairmont Ave.

Applicant

Name: Clem Kutzli
Address: 825 Clairmont Ave

Approval Date: 6/3/2009
419-592-6456

Owners

Name: Clem Kutzli
Address: 825 Clairmont Ave
Napoleon, OH 43545

Phone: 419-592-6456

Contractors

Fees and Receipts:

Number	Description	Amount
FEE2009-494	Building	\$25.00
FEE2009-495	State 1% fee (Calc)	\$0.25
Total Fees:		\$25.25
RCPT2009-334		\$25.25
Total Receipts:		\$25.25

Deck

APPLICANTS SIGNATURE: _____ DATE: _____

REMINDER: YOU MUST CALL (419)592-4010 FOR AN INSPECTION

CITY OF NAPOLEON GENERAL PERMIT APPLICATION

THIS APPLICATION IS FOR RESIDENTAL CONSTRUCTION INCLUDING BUILDING, ELECTRICAL, PLUMBING, MECHANICAL, DEMOLITIONS & REMODELING

DATE 6/3/09 JOB LOCATION 825 Clairmont
 OWNER Clem Kutzli TELEPHONE # 592-6456
 OWNER ADDRESS 825 Clairmont
 CONTRACTOR Owner CELL PHONE # _____
 DESCRIPTION OF WORK TO BE PERFORMED Deck on Front of house
 ESTIMATED COMPLETION DATE 6/7/09 ESTIMATED COST \$ 700.00

Affected Floor Area (AFA): In existing structures, it is the area affected by the improvement, i.e. a new wall dividing a room (the AFA would be only the room and not all the rooms).

DESCRIPTION	FEE	TOTAL COST
<i>Addition & Alterations</i> Square foot in (AFA) x \$0.05 = \$	+	\$25.00 = \$
<i>Electrical</i> Circuits in (AFA) x \$3.00/Circuit = \$	+	\$25.00 = \$
<i>Plumbing</i> Traps in (AFA) x \$3.00/Trap = \$	+	\$25.00 = \$
<i>Siding and/or Roofing</i>		\$25.00 \$
<i>Windows/Doors</i>		\$25.00 \$
<i>Decks</i>		\$25.00 \$ <u>25.00</u>
<i>Garage and Shed over 250 SF (Detached)</i>		\$25.00 \$
<i>Electrical Service Upgrade</i>		\$25.00 \$
<i>Water Heater</i>		\$25.00 \$
<i>Furnace and/or AC Replacement</i>		\$25.00 \$
	MBP (100.3100.46510)	Subtotal: \$
	(100.0000.42700) PLUS Ohio Board of Building Standards Fee + 1%	\$ <u>.25¢</u>

TOTAL FEE: \$ 25.25

I FULLY UNDERSTAND THAT NO EXCAVATION, CONSTRUCTION OR STRUCTURAL ALTERATION, ELECTRICAL OR MECHANICAL INSTALLATION OR ALTERATION OF ANY BUILDING STRUCTURE, SIGN, OR PART THEREOF AND NO USE OF THE ABOVE SHALL BE UNDERTAKEN OR PERFORMED UNTIL THE PERMIT APPLIED FOR HEREIN HAS BEEN APPROVED AND ISSUED BY THE CITY OF NAPOLEON BUILDING/ZONING DEPARTMENT.

I hereby certify that I am the Owner of the named property, or that the proposed work is authorized by the Owner of record and that I have been authorized by the Owner to make this application as his/her authorized agent and I agree to conform to all applicable laws of the jurisdiction. In addition, if a permit for Work described in this application is issued, I certify that the code official or the code official's authorized representative shall have the authority to enter areas covered by such permit at any reasonable hour to enforce the provisions of the code(s) applicable to such permit.

I HEREBY ACKNOWLEDGE THAT I HAVE READ AND FULLY UNDERSTAND THE ABOVE LISTED INSTRUCTIONS.

SIGNATURE OF APPLICANT: _____ DATE: _____

PRINT NAME: _____

BATCH # 20784 CHECK # Cash DATE 06-03-09

Clear Kotali - Q25 Clearmont - S52 G456

House

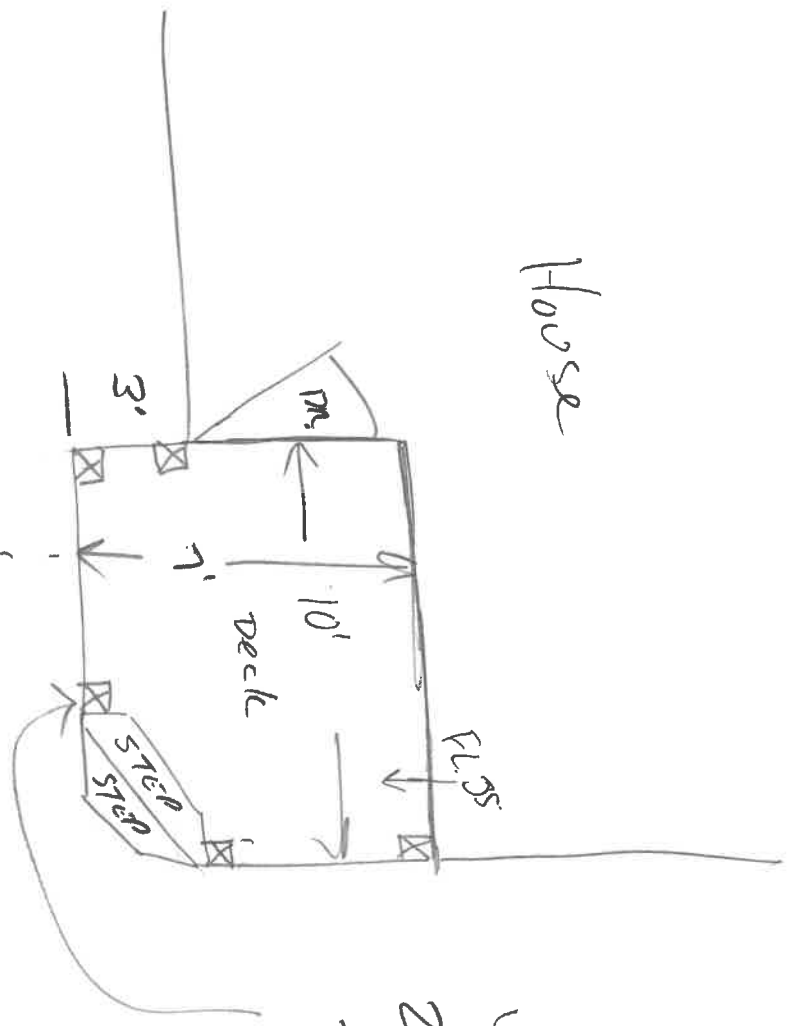

Vertical rails less than 4" apart
2x6 Floor Ssk.
Double 2x6 Beam

Drive Way